

## 36 inch Freestanding French Door Heritage Series

\$ 2,799



### **REF36FDFIXNV**

The Bertazzoni 36" French-door stainless steel refrigerator is designed and engineered with the highest grade materials and components. Using one of the 3 available handle kits in Professional, Master and Heritage Series style, this refrigerator integrates seamlessly with all other Bertazzoni appliances into style-harmonized suites for a true, high-performing kitchen.

This counter-deep refrigerator has ample storage capacity, with 15.9 cubic feet of refrigerator volume and 6.6 cubic feet of freezer. Dual air-cooling flow with independent no-frost system for refrigerator and freezer compartments provide optimal temperature and humidity control to keep food fresher longer. The internal configuration of the upper compartment is designed for maximum flexibility, with shelves that move and fold, high-capacity drawers and crispers with dedicated humidity controls, and several gallon-size storage bins in both doors. Two freezer drawers allow easy access, and the top compartment holds the tray for the automated ice-maker.

Using one of the 3 available handle kits in Professional, Master and Heritage Series style, this refrigerator integrates seamlessly with all other Bertazzoni appliances into style-harmonized suites for a true, high-performing kitchen.

Handle kits are sold separately.

All Bertazzoni appliances are covered by a 2-year warranty.

[Guarda online](#)

# Specifications

## Features

### General features

Size	36 in
Cooling system	frost free
User interface	LED touch control interface
Display functions	Super Cool, Super Freeze, Ice maker
Lighting	LED side & top rail illumination
Door ajar alarm	yes
Door finishing	stainless finish
Cabinet finishing	white
Refrigerator net capacity	15.9 cu.ft <sup>3</sup>
Refrigerator shelves	4 height-adjustable, of which 1 retractable + 1 stationary
Refrigerator drawers	1 large with preset temperature + 2 medium with adjustable humidity
Door storage	6 gallon-sized bins
Freezer net capacity	6.6 cu.ft <sup>3</sup>
Freezer drawers	2 full extension drawers
Automatic ice maker	yes
Ice production capacity	3.08 lbs / 24h
Water supply pressure	21-120 PSI
Sound rating	45 dbA
Certification	CEC, UL

### Technical specifications

Electrical supply	115 V - 60 Hz - 2.5 A
Power rating	190 W
Power connection	NEMA 5-15P with 67" power cord
Energy consumption	588.0 kwh/yr

---

# Dimensions

---

FRONT

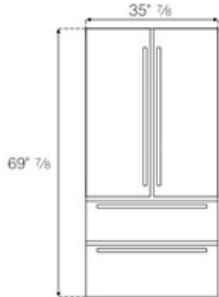

SIDE

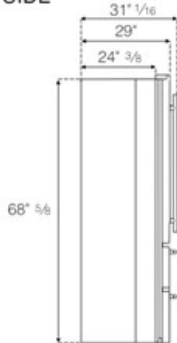

TOP

